

Shoulder Screws, ISO 7379

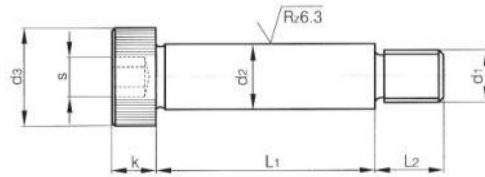

d2h8	6	8	10	12	16	20	24
d1	5 X 0,8	6 X 1	8 X 1,25	10 X 1,5	12 X 1,75	16 X 2	20 X 2,5
d3	10	13	16	18	24	30	36
K	4,5	5,5	7	8	10	14	16
L2	9,5	11	13	16	18	22	27
S	3	4	5	6	8	10	12
Kg/mm	0,68	1,15	3	6	11	28	55

L1	L1 h11						
10	*						
12	*	*					
16	*	*	*				
20	*	*	*	*			
25	*	*	*	*	*		
30	*	*	*	*	*	*	
35	*	*	*	*	*	*	
40	*	*	*	*	*	*	*
45	*	*	*	*	*	*	*
50	*	*	*	*	*	*	*
55		*	*	*	*	*	*
60		*	*	*	*	*	*
65		*	*	*	*	*	*
70		*	*	*	*	*	*
80			*	*	*	*	*
90				*	*	*	*
100				*	*	*	*
120				*	*	*	*

Material: High tensile strength (12.9).
ISO 7379.

Order example
UNBH+d2+L1 ex. UNBH610 (6 x 10 mm).