

DOWEL PINS

Dowel Pins - Threaded - DIN 7979

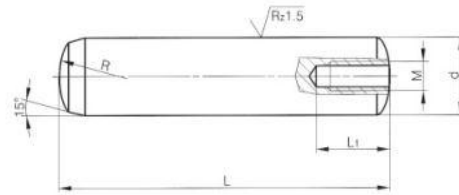

L1	10	12	16	16	20	20	25	
L	d	Ø 6 M4	Ø 8 M5	Ø 10 M6	Ø 12 M6	Ø 14 M8	Ø 16 M8	Ø 20 M10
16		*	*					
18		*	*					
20		*	*	*	*			
24		*	*	*	*			
28		*	*	*	*			
32		*	*	*	*		*	
36		*	*	*	*	*	*	
40		*	*	*	*	*	*	*
45		*	*	*	*	*	*	*
50		*	*	*	*	*	*	*
55		*	*	*	*	*	*	*
60		*	*	*	*	*	*	*
70		*	*	*	*	*	*	*
80		*	*	*	*	*	*	*
90		*	*	*	*	*	*	*
100		*	*	*	*	*	*	*
110			*	*	*	*	*	*
120			*	*	*	*	*	*

Surface: Hardened and Polished.
 Material: 1.3505.
 Tolerance: m6.
 Hardness: 60 ± 2 HRC.

Order example
 CYLG+d+L ex. CYLG832 (8x32mm).