

VGE. – Elbow Arm for Vacuum Cups

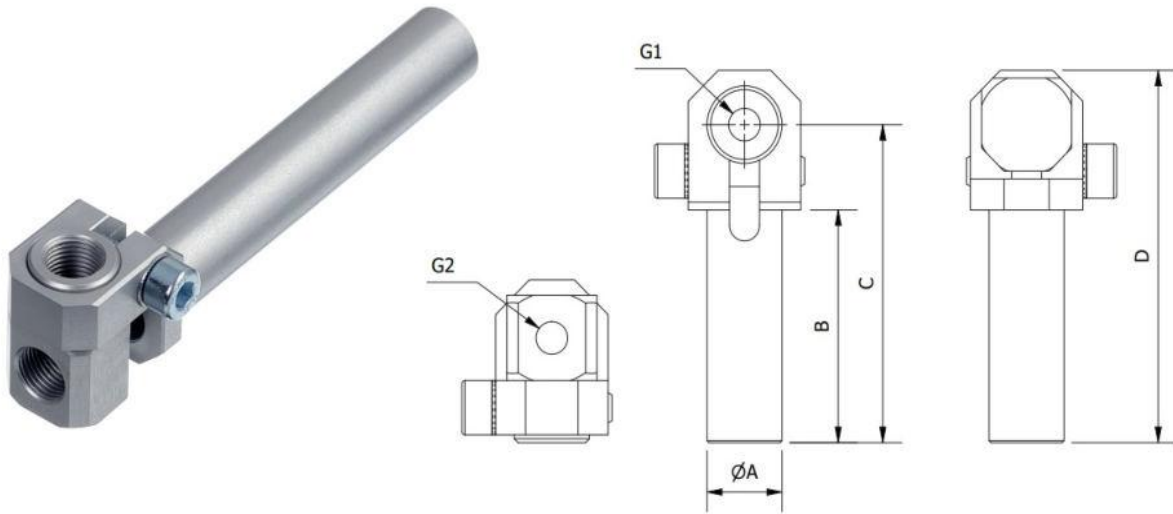

Part No.	A	B	C	D	G1	G2	Weight (g)
VGE.10030.0505	10	30	41	48	M5	M5	14
VGE.10060.0505	10	60	71	78	M5	M5	17
VGE.10090.0505	10	90	101	108	M5	M5	20
VGE.14040.1818	14	40	56	65	G1/8	G1/8	29
VGE.14080.1818	14	80	96	105	G1/8	G1/8	38
VGE.14120.1818	14	120	136	145	G1/8	G1/8	45
VGE.20050.1418	20	50	68	80	G1/8	G1/4	56
VGE.20100.1418	20	100	118	130	G1/8	G1/4	70
VGE.20150.1418	20	150	168	180	G1/8	G1/4	87
VGE.20050.1414	20	50	68	80	G1/4	G1/4	55
VGE.20100.1414	20	100	118	130	G1/4	G1/4	69
VGE.20150.1414	20	150	168	180	G1/4	G1/4	86

Allows optimal positioning of vacuum to part contour.
 Angle adjustable between 0° and 90°.
 Side vacuum port.