

**Straight Coupling**

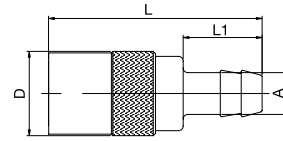

DN	Series	↔	↔	A	D	L	L1	📦
4,5	20	20K6V	20K6	6	18	46	17	10
6		20K10V	20K10	10	18	51	22	10
7		20K13V	20K13	13	18	51	22	10
7	30	30K10V	30K10	10	24	64	22	10
9		30K13V	30K13	13	24	66,5	25	10
15	50	50K19V	50K19	19	32	89	32	5

**Safety Coupling, Type TS, Straight**

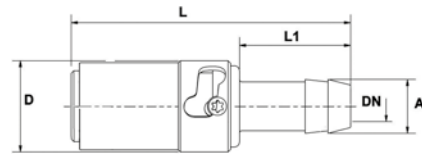

DN	Series	↔	↔	A	D	L	L1	📦
6	20	20K10V-TS	20K10-TS	10	18	59,5	22	5
7		30K10V-TS	30K10-TS	10	23	64,5	25	5
9	30	30K13V-TS	30K13-TS	13	23	64,5	25	5
15		50	50K19V-TS	50K19-TS	19	32	90,8	34

**Push Lock - Straight Coupling**

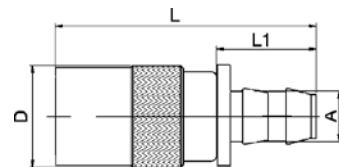

DN	Series	↔	↔	A	D	L	L1	📦
6	20	20K10V-PL	20K10-PL	10	18	58	28	10
9		30K10V-PL	30K10-PL	10	24	64,5	28	10
	30	30K13V-PL	30K13-PL	13	24	64,5	28	10

**90° Coupling**

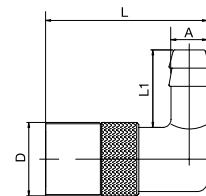

DN	Series	↔	↔	A	D	L	L1	📦
4,5	20	20K6V/90	20K6/90	6	18	40	19	10
6		20K10V/90	20K10/90	10	18	40	22	10
7	30	30K10V/90	30K10/90	10	24	56	22	10
9		30K13V/90	30K13/90	13	24	56	28,5	10
15	50	50K19V/90	50K19/90	19	32	77	32	5

