

Ball Valve Standard Handle - Male / Female

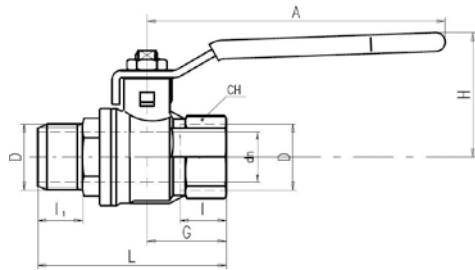

| Part No. | Part No. | D | DN | I | I1 | L | G | A | H | CH |
|----------|----------|--------|-----|------|------|------|------|-----|----|----|
| VLMF04R | VLMF04B | 1/4" | 8 | 12 | 13,5 | 56,5 | 22,5 | 82 | 38 | 20 |
| VLMF06R | VLMF06B | 3/8" | 9,5 | 12 | 13,5 | 56,5 | 22,5 | 82 | 38 | 20 |
| VLMF08R | VLMF08B | 1/2" | 15 | 15,5 | 16,5 | 70 | 29,5 | 100 | 43 | 25 |
| VLMF12R | VLMF12B | 3/4" | 19 | 17 | 18 | 76,5 | 32 | 120 | 50 | 31 |
| VLMF16R | VLMF16B | 1" | 24 | 21 | 22 | 92,5 | 40,5 | 120 | 54 | 40 |
| VLMF20R | VLMF20B | 1-1/4" | 30 | 23 | 24 | 106 | 46,5 | 158 | 73 | 49 |
| VLMF24R | VLMF24B | 1-1/2" | 38 | 23 | 24 | 113 | 51 | 158 | 79 | 54 |

Ball Valve Standard Handle - Female / Female

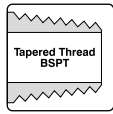
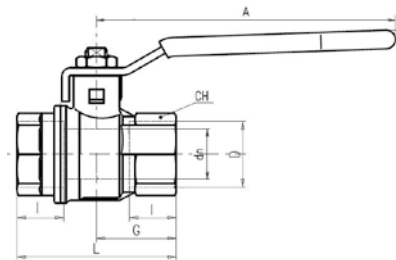

| Part No. | Part No. | D | DN | I | L | G | A | H | CH |
|----------|----------|--------|-----|------|-----|------|-----|----|----|
| VL04R | VL04B | 1/4" | 8 | 12 | 45 | 22,5 | 82 | 38 | 20 |
| VL06R | VL06B | 3/8" | 9,5 | 12 | 45 | 22,5 | 82 | 38 | 20 |
| VL08R | VL08B | 1/2" | 15 | 15,5 | 59 | 29,5 | 100 | 43 | 25 |
| VL12R | VL12B | 3/4" | 19 | 17 | 64 | 32 | 120 | 50 | 31 |
| VL16R | VL16B | 1" | 24 | 21 | 81 | 40,5 | 120 | 54 | 40 |
| VL20R | VL20B | 1-1/4" | 30 | 23 | 93 | 46,5 | 158 | 73 | 49 |
| VL24R | VL24B | 1-1/2" | 38 | 23 | 102 | 51 | 158 | 79 | 54 |

Quality:

- 24h 100% seal test guaranteed.
- Dual sealing system allows valve to be operated in either direction making installation easier.
- No maintenance ever required.
- Chrome plated brass ball for longer life.
- Travel stops on body to avoid stresses at stem.

Body:

- Hot forged sand blasted, nickel plated brass body and cap sealed with Loctite or equivalent thread sealant.
- Finest brass according to EN 12165 and EN 12164 (formerly DIN 17660 and UNI 5705-65) specifications.

Flow:

- Full port to DIN 3357 for maximum flow.

Thread:

- EN 10226-1, ISO 228 Male thread: BSPT – Female thread: BSPP.

Stem:

- Two FPM O-rings at the stem for maximum safety.

Seals:

- Pure PTFE self-lubricating seats with flexible-lip design.

Working Pressure:

- 40 Bar (600 PSI).
- Non-shock cold working pressure.

Operating Temperature:

- +170°C (+350°F).

