

# VACUUM CUP ADAPTORS

## Telescopic Self-Retracting Suspension

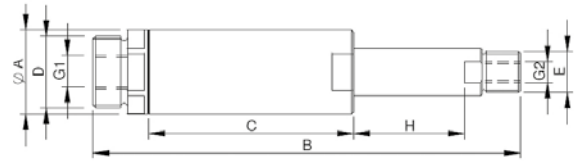

Part No.	A	B	C	D	E	G1	G2	H	F(N)	Weight
MPTSS2025	20	100	48	M17x1	G 1/8	G 1/8	M5	25	3.6	42 g
MPTSS2050	20	150	73	M17x1	G 1/8	G 1/8	M5	50	4.2	68 g

Extremely light weight (Material Aluminium).  
 Guide (Tube and shaft) hard coated.  
 Sealing with no seals.  
 Only for vacuum applications.

When the cup takes a part, the vacuum on the internal piston overtakes the spring force and moves the rod up.  
 The speed of the retraction movement can be adjusted by a standard throttle valve.  
 When the vacuum is removed the part is released and the internal spring resets the rod.  
 Pressure range: -1 ÷ 0 bar.

## Smooth Body Non-Rotative Telescopic Suspension

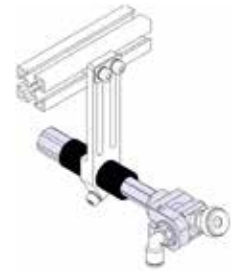
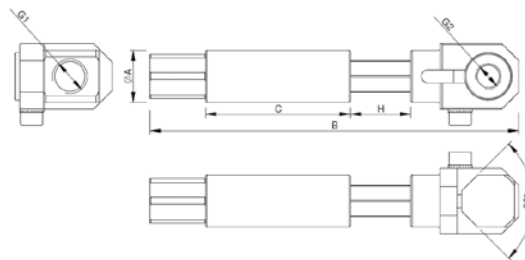

Part No.	A	B	C	G1	G2	H	F(N)	Weight
MPSSN10100505	10	56	21	M5	M5	10	3.6	19 g
MPSSN10250505	10	90.5	40.5	M5	M5	25	3.7	22 g
MPSSN14201818	14	98.5	38.5	G 1/8	G 1/8	20	8.9	45 g
MPSSN14351818	14	148	60	G 1/8	G 1/8	35	9.5	51 g
MPSSN20251418	20	110	49	G 1/4	G 1/8	25	11	105 g
MPSSN20501418	20	167.5	81.5	G 1/4	G 1/8	50	11.4	110 g

H= Spring deflection.  
 Material: Aluminium /Brass .

