

## FRAME CONNECTORS

### Nuts for Profile

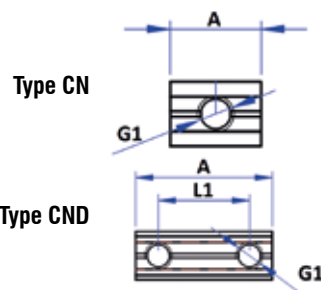

Part No.	G1	A	L1
CN-M3	M3	15	
CN-M4	M4	15	
CN-M5	M5	15	
CN-M6	M6	15	
CND-M4	M4	24	16
CND-M5	M5	30	20
CND-M6	M6	30	20

### Profile Connector - Straight

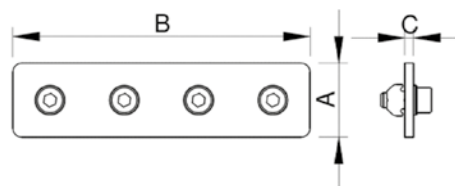

Part No.	A	B	C	Profile
MP.VBG.X.25.50	25	50	3	X
MP.VBG.X.50.50	50	50	3	X
MP.VBG.L.40.80	40	80	3	L

### Profile Connector L-Style

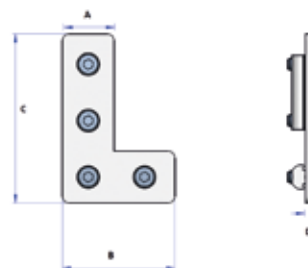

Part No.	A	B	C	D
MA.VBL.50.50	25	50	50	3
MA.VBL.50.75	25	50	75	3
MA.VBL.80.80	40	80	80	3
MA.VBL.80.120	40	80	120	3