

# CUSTOM NOZZLE TIP FORM

SPECIFY

**1. External Style of Nozzle Tip:**

- Standard     Flat Face\*

**2. Internal Design of Nozzle Tip:**

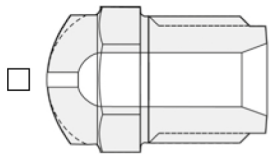

General Purpose Internal Design

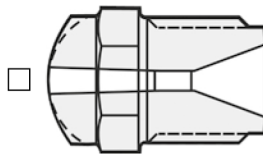

Nylon Internal Design

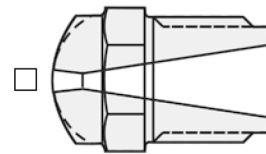

Full Taper Internal Design

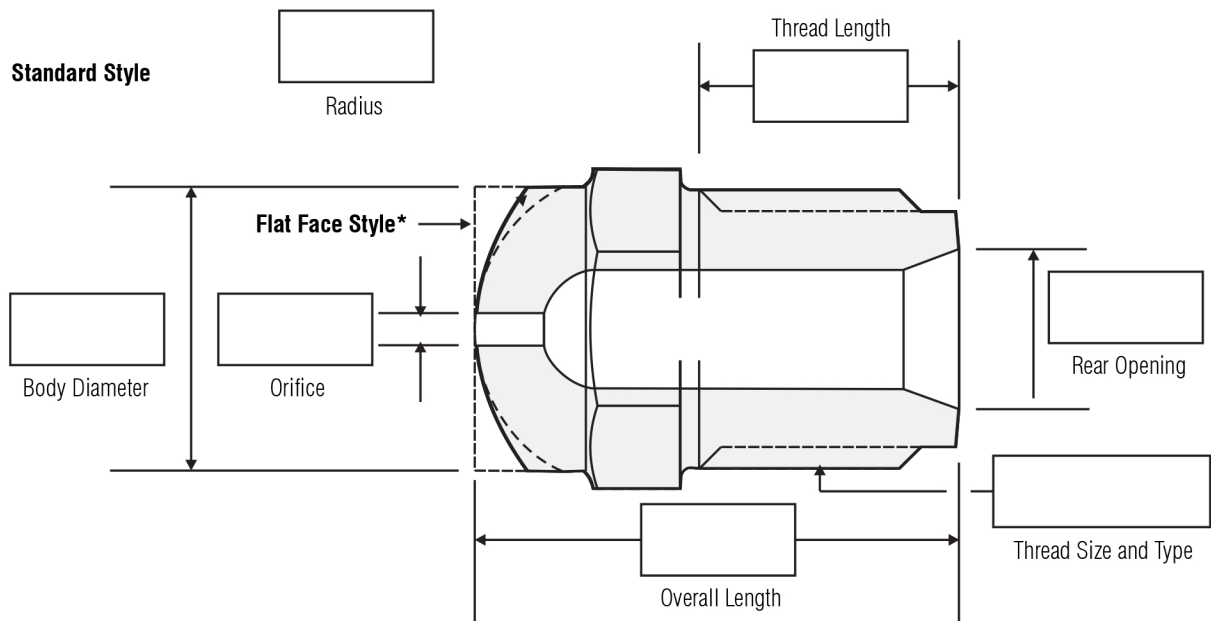

Date: \_\_\_\_\_

Name \_\_\_\_\_

Company \_\_\_\_\_ Email \_\_\_\_\_

Address \_\_\_\_\_

City \_\_\_\_\_ Zip \_\_\_\_\_

Country \_\_\_\_\_